

PBMPJ - Low Voltage Cable Joint

Hydrocarbon Resistant Cable Joints for OGP Applications



Straight Joints for oil refinery type cables - EEMUA-133 lead sheathed & SWA and Polyamide + Aluminium laminate & SWA.

This range of joints is based on the Prysmian Low Hazard JEM Resin encapsulation together with rigid glass reinforced outer shells which provide excellent resistance to the hydrocarbons.

Features and benefits:

- Rated Voltage 1000V
- Tested and approved to:
 - BS EN 50393:2015
 - Test Methods and requirements for accessories for use on distribution cables of rated voltage 0.6/1.0 (1.2) kV.
- BS 6899 - Oil resistance
- Low Hazard Isocyanate free JEM resin
- Twin pack mixing in clear laminate sachets
- Extremely low viscosity resin with enhanced adhesion
- Rigid glass reinforced phenolic joint shells which are chemical resisting.
- Requires compression or mechanical connectors which are supplied separately.

Technical Information:

- Low Voltage Straight joints for EEMUA 133 type lead sheathed SWA cables, Polyamide + aluminium laminate SWA cables (Drylam types with and without drain-wires) and standard XLPE/PVC SWA cables.

- Tested and approved to BS EN 50393:2015.

General Technical Data:

In this range a Phenolic resin shell is used to provide excellent resistance to Hydrocarbons found in Oil, Gas and Petrochemical installations. Tests to demonstrate the chemical resistance of both the shell and the sealing putty have been carried out to BS6899 using ASTM oils, numbers 2 and 3. This calls for 24 hour immersion at 100°C and specifies permissible changes in mechanical properties before and after ageing. In each case minimal changes were observed after immersion in both oils, under conditions where most conventional polymers used in cable construction would not survive.

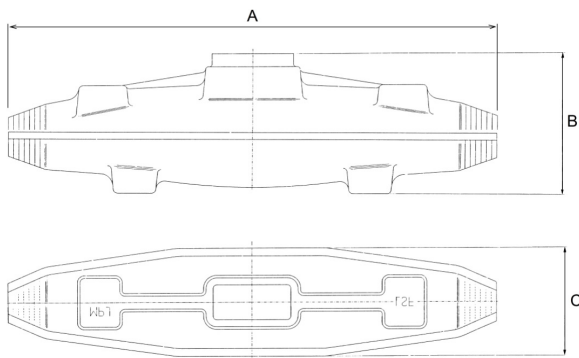

Shell Dimensions LV Straight (mm)				Cable Diameter	
Joints Ref.	A	B	C	Min	Max
PBMPJ4	405	100	80	20	39.5
PBMPJ5	430	110	90	25	57
PBMPJ6	560	160	130	38	74.5
PBMPJ7	740	180	145	44	92

Conductor	Joint Selection			LV Compression	LV Mechanical
	Two Core	Three Core	Four Core	Copper	Copper & Aluminium
1.5 mm ²	PBMPJ4	PBMPJ4	PBMPJ4	BERS	-
2.5 mm ²	PBMPJ4	PBMPJ4	PBMPJ4	BEBS	-
4 mm ²	PBMPJ4	PBMPJ4	PBMPJ4	BEYS	BMT16
6 mm ²	PBMPJ4	PBMPJ4	PBMPJ4	BT6CS	BMT16
10 mm ²	PBMPJ4	PBMPJ4	PBMPJ4	BT10CS	BMT16
16 mm ²	PBMPJ4	PBMPJ4	PBMPJ5	BT16CS	BMT35
25 mm ²	PBMPJ5	PBMPJ5	PBMPJ5	BT25CS	BMT35
35 mm ²	PBMPJ5	PBMPJ5	PBMPJ5	BT35CS	BMT70
50 mm ²	PBMPJ5	PBMPJ5	PBMPJ5	BT50CS	BMT70
70 mm ²	PBMPJ5	PBMPJ5	PBMPJ5	BT70CS	BM95M
95 mm ²	PBMPJ5	PBMPJ5	PBMPJ6	BT95CS	BM185M
120 mm ²	PBMPJ6	PBMPJ6	PBMPJ7	BT120CS	BM185M
150 mm ²	PBMPJ7	PBMPJ7	PBMPJ7	BT150CS	BM185M
185 mm ²	PBMPJ7	PBMPJ7	PBMPJ7	BT185CS	BT185CS
240 mm ²	PBMPJ7	PBMPJ7	PBMPJ7	BT240CS	BM300M
300 mm ²	PBMPJ7	PBMPJ7	PBMPJ7	BT300CS	BM300M